

RECEIVED

SEP 16 2020

INLAND WETLANDS

77 Edgewater Drive, Coventry, CT

Wall – Proposed Scope of Work (taken from Contractor quote)

- Natural Stone Wall to be reconstructed on the existing footprint using larger stone and fieldstone totaling approximately 450 face feet with natural stone steps
- Demo and remove the deteriorating concrete wall from site
- Add a 'dry' compacted footing of crushed stone, install appropriate drainage and construct a new retaining wall with a maximum height of 48"
- Create a boulder wall with sod ramp on western edge of property to launch kayaks, paddle boards, etc.
- Construction includes all excavation, adding footing, all drainage, back filling, perforated pipe, fabric, crushed stone backfill, and site repair; once finished include soil, seeding/repairing of disturbed lawn areas

Patio – Proposed Scope of Work (taken from Contractor quote)

- Construct a new paver patio of approximately 600 square feet using permeable pavers
- Paver areas to be prepared with a base layer of processed gravel followed by a secondary layer of stone dust; pavers to be finished/swept with a fine material and all materials to be compacted

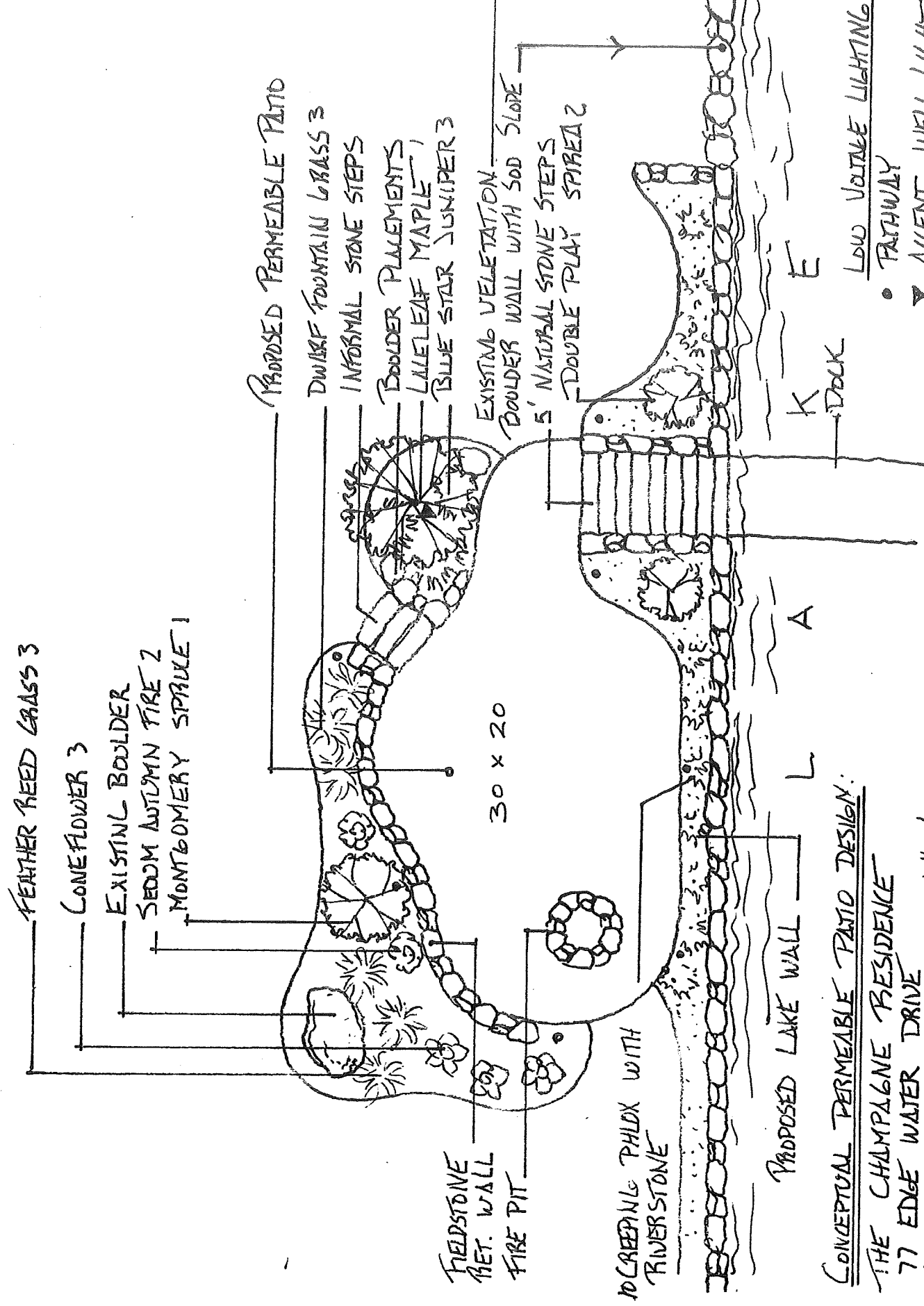

FEATHER REED GRASS 3
 CONEFLOWER 3
 EXISTING BOULDER
 SEDUM AUTUMN FIRE 2
 MONTGOMERY SPRAKE 1

PROPOSED PERMEABLE PATIO
 DWARF FOUNTAIN GRASS 3
 INFORMAL STONE STEPS
 BOULDER PLACEMENTS
 LALELEAF MAPLE 1
 BLUE STAR JUNIPER 3

EXISTING VEGETATION
 BOULDER WALL WITH SOD SLOPE
 5' NATURAL STONE STEPS
 DOUBLE PLAY SPIRAL 2

FIELDSTONE
 RET. WALL
 FIRE PIT

30 x 20

10 CREEPING PHLOX WITH
 RIVER STONE

PROPOSED LAKE WALL

K DOCK

CONCEPTUAL PERMEABLE PATIO DESIGN:

THE CHAMPAGNE RESIDENCE
 77 EDGE WATER DRIVE
 COVENTRY, CT
 PREPARED BY: CREATIVE EXTERIORS LLC

LOW VOICE LIGHTING
 • PATHWAY
 ▽ ACCENT WELL LIGHT